

*“It’s the NATURE  
of our Business”*



## PARK HOURS

8:00 A.M. — DUSK,  
SEVEN DAYS A WEEK

*(except Thanksgiving Day, Christmas Eve,  
Christmas Day and New Year’s Day)*

## TELEPHONE

c/o Blue Jay Point County Park  
(919) 870 – 4330

## PARK RULES AND REGULATIONS

Wake County Government desires to provide a safe and enjoyable experience for all patrons of the North Wake Landfill District Park. With this in mind, please adhere to the following rules & regulations:

1. NO open flames or fires, NO grills of any kind, NO fireworks, and NO smoking. This innovative park is located adjacent to a recently closed landfill with a landfill gas (55% methane) collection system, and we must eliminate the potential for grass fires.
2. Remain on the designated paths around and on the landfill at all times. To prevent injury, do not walk or ride bikes on the slopes of the landfill. You may access the top of the landfill from the "Top of the Hill Trail" located near the park entrance sign.
3. Speed limit is 20 mph.
4. Pets must be kept on a leash no longer than 6 feet. (Please clean up after your pet.)
5. Park only in designated areas, not along road shoulders.
6. The following are prohibited:
  - *Alcoholic beverages*
  - *Firearms*
  - *Feeding of wildlife in the park*
  - *Hunting*
  - *Overnight camping*
  - *Collection, removal or release of any plant, animal, or mineral material*
  - *Open flames and grills-see above*

*Please help keep our parks beautiful. Place trash and recycling in the appropriate containers.*

*Information is available at the park office or you can visit us at:*

[www.wakegov.com/parks](http://www.wakegov.com/parks)



North Wake Landfill District Park  
9300 Deponie Drive  
Raleigh, NC 27614  
c/o Blue Jay Point County Park  
(919) 870 - 4330

[www.wakegov.com/parks/northwake](http://www.wakegov.com/parks/northwake)

# North Wake Landfill District Park



Parks, Recreation  
& Open Space

# What's the Big Hill?

Between 1996 and 2008, the North Wake Landfill accepted much of the solid waste generated by Wake County residents. The landfill hill covers 73 acres, holds 4.8 million tons of waste, and rises over 190 feet above the concrete road that encircles the hill.

## How did it become a park?

Closed landfills have been repurposed into parks for many years. In 2004 a group was formed with residents to plan how the site would be used after the landfill closed. The final Master Plan includes ideas from the local citizens, and addresses regulatory constraints with operating a closed solid waste landfill. When the landfill closed in 2008, the park facilities of the first phase in the multi-phase Master Plan were constructed and the park opened in July 2010. Other phases of the plan will proceed as funding becomes available.

## What happens to the waste that was placed in the landfill?

Organic wastes will decompose with time producing landfill gasses, including methane, and liquids called leachate. Other materials, such as paper, plastics, clothing, metals, and other man-made items, will remain in the landfill indefinitely.

## What keeps leachate and waste in the landfill?

The landfill base is lined with compacted clay, a plastic membrane, and a rock layer. The clay and plastic keep the leachate from contaminating streams or groundwater. The rock layer filters the leachate which is pumped to a leachate pond and then to the City of Raleigh's sanitary sewer system for treatment. A similar clay and plastic liner system caps off the landfill beneath the grassy slopes. The black pipes coming from the base of the landfill at the perimeter road provide access to the leachate collection system for inspection and cleaning.

## How do we know the liner system is working?

Engineers carefully monitor that the liner system is installed correctly. This includes rigorous testing of the materials used and of each weld used to bind the individual sheets of the plastic membrane. Groundwater monitoring wells surrounding the landfill are sampled twice a year for any indication of groundwater contamination.

## How is the landfill gas collected from the landfill?

A series of vertical gas collection wells can be seen on the side slopes and top of the landfill. These wells extend into the waste and collect landfill gas. Gas collected by the wells is routed through a series of pipes located in the cap to the flare station.



## What does the flame/flare do?

The flare burns landfill gas that is created as the organic waste in the landfill decomposes. Methane found in the landfill gas can be used to produce energy for beneficial uses, such as to power industrial processes or to produce alternative "green" energy. Currently, gas generated by the landfill is collected to fuel processes at a nearby industry. The volume of gas that can't be used by that industry is destroyed in the flare to eliminate the potential greenhouse gas emission.

## What does Wake County do with its waste now?

Wake County operates a municipal solid waste landfill located in the southern part of the county on NC Highway 55 near Holly Springs. This new facility is expected to receive waste until approximately 2033.

# NORTH WAKE LANDFILL DISTRICT PARK

## LEGEND

-  Paved Trail
-  Hiking or Mountain Biking Trail
-  Abbotts Creek Trail
-  Paved Road
-  Trail Access Gates
-  Emergency Vehicle Access Only
-  Mountain Bike Skills Area
-  Parking
-  Picnic Area
-  Restrooms
-  Playground
-  Shelter

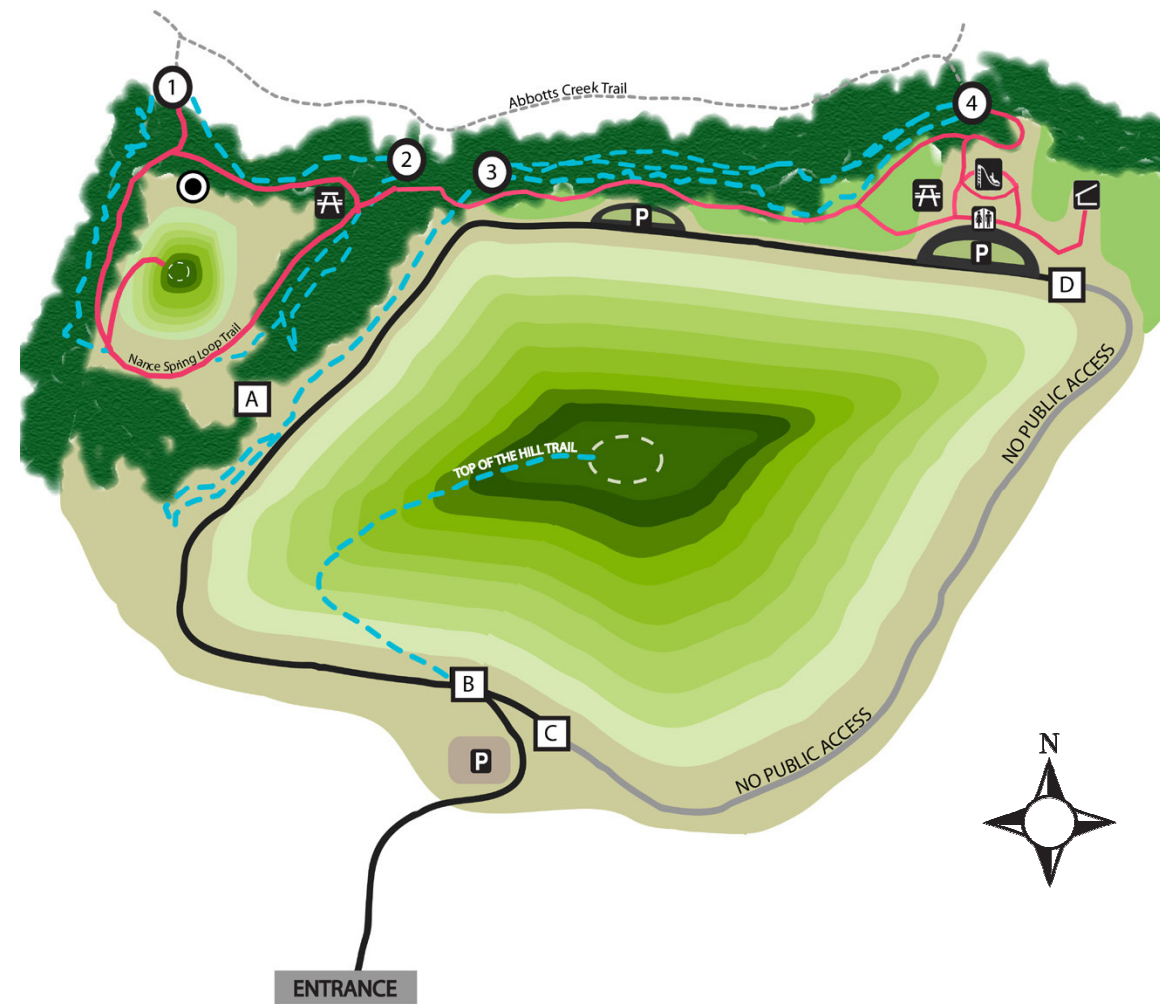

### Top of the Hill Trail (.07 mile)

You can climb less than a tenth of a mile to the top of the hill (469 feet above sea level) and you will be rewarded with a nice view of the surrounding area including downtown Raleigh. Please stay on the trail to the top of the hill. The slope of the landfill is off limits (for more information, see question "how landfill gas is collected" inside this brochure).



### Playground and Open Play Area

The climbing wall and the big climbing web are highlights of this fun playground! The playground is unsupervised and includes a kid's lot (ages 5-12) and a tot lot (ages 2-5).



### Sycamore Picnic Shelter and other picnic areas

The shelter is available on a first-come, first-served basis. There are 10 regular tables and 2 wheelchair accessible tables for seating up to 100 people. There are other picnic tables located at the playground, the Mountain Bike Skills Area, near the Nance Spring Loop Trail, and on the top of the hill.

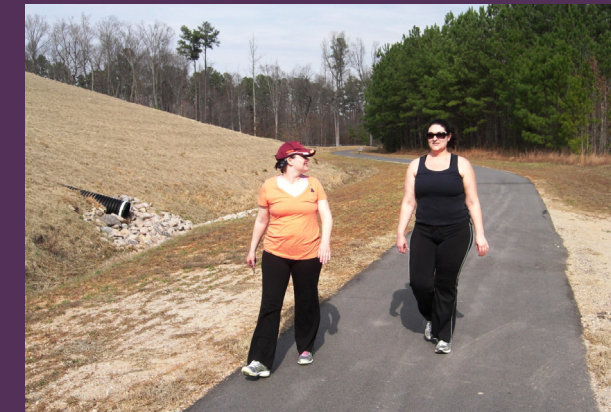

### Paved Trails (1.8 miles)

The paved walking trails connect all of the park amenities and also include the popular Nance Spring Loop Trail, which is 0.4 miles. The park's paved trails also connect to the Capital Area Greenway System (for more information, please look on the City of Raleigh's website).



### Hiking and Mountain Bike Trails (2 miles)

There are 2 miles of hiking and mountain bike trails. These trails are used by hikers and mountain bikers. Please remember that "Wheels yield to Heels" (bikers yield to pedestrians). Please be courteous to all users on the trail.



### Mountain Bike Skills Area

This area is provided for those wishing to build their mountain biking skills, increase their comfort level and enjoy technical riding. Please be mindful of your ability and follow the posted rules. This area and the mountain bike trails are maintained by TORC (Triangle Off Road Cyclists). To volunteer, please check out their website [www.torc-nc.org](http://www.torc-nc.org).